

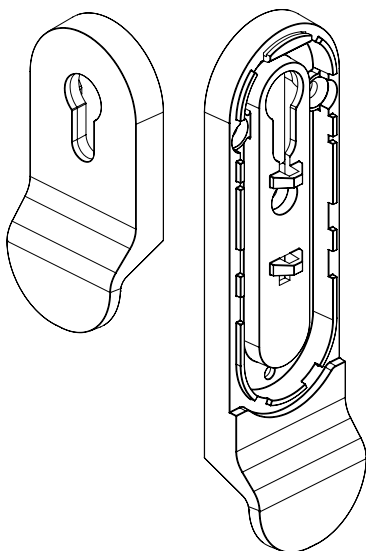

Linus® L2 Pull Escutcheon Fitting Instructions



Contents

Linus® L2 Pull Escutcheon overview	2
Inside the box	3
Changing your existing cylinder	4
Installing your Linus® L2 Pull Escutcheon	6
Installing the Linus® Smart Lock L2	9
Setting up the Linus® Smart Lock L2	12

Linus® L2 Pull Escutcheon Overview

Internal

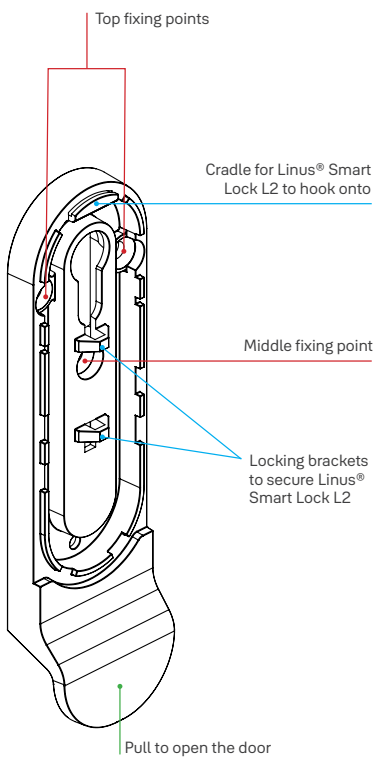

External

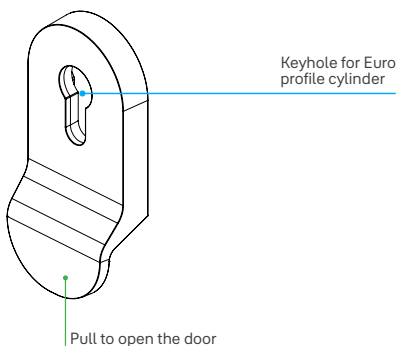

Before you start

The Linus® Smart Lock L2 will be mounted on the internal side of your door, your new Linus® L2 Pull Escutcheon will be the cradle for this.

1. Check you have all relevant parts in your box – Refer to the 'What's in the box' section. 
2. Ensure you have the correct tools to hand.
3. Remove the existing door hardware by removing any covers or screw caps and make a note of the location of the fixing points.
4. Remove the screws to use as a guide to select the equivalent Linus® versions and set aside.



Please ensure the door is kept in an 'open position' until the new escutcheon & Linus® Smart Lock L2 are fitted.

What's in the box

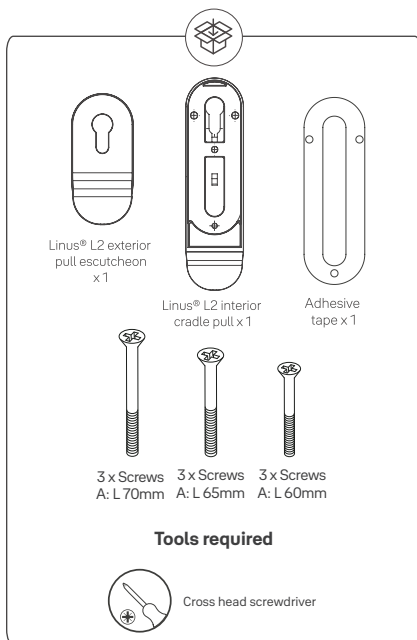

Changing / Installing the Cylinder

To ensure your Linus® Smart Lock L2 works correctly and maintains all features, we may recommend changing your cylinder. To do this, please use the following directions.

If you struggle to remove the cylinder with the hardware in place, please stop, remove the hardware & then try again.

Please scan the QR code to quickly check if you need to change your cylinder and whether you need to use the thumbturn adapter supplied with your Linus® Smart Lock L2.



1

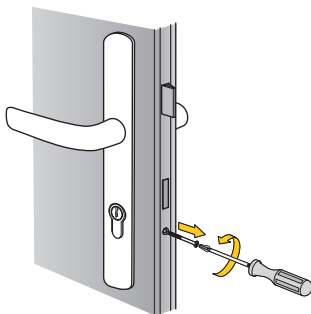

Remove (but keep safe) the screw to release the cylinder.

2

 **Turn the key in both directions to align the cam with the cylinder housing (as shown above)**

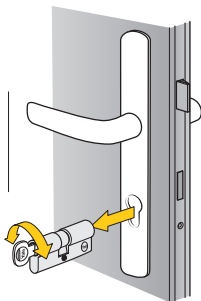

Remove the old cylinder. Use the key to align the cam (moving mid section) with the cylinder housing in order to push in/pull out the cylinder

Changing / Installing the Cylinder

3

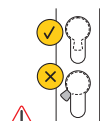

Turn the key in both directions to align the cam with the cylinder housing (as shown above)

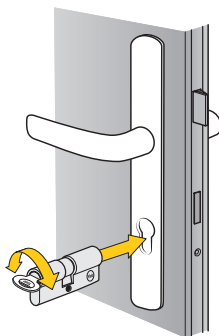

Insert the new cylinder with the cam aligned with the cylinder housing (as shown above).

4



Check if the key turns and the lock operates correctly. If the key turns easily, the cam is aligned. If not, adjust cylinder position slightly and try again.

5

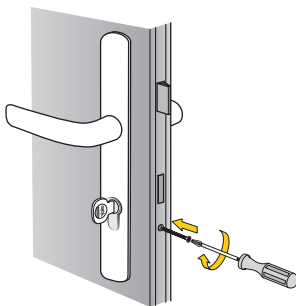

When aligned correctly, the lock should operate smoothly and the screw can be replaced to secure the cylinder. If a smooth operation is not achieved, your Linus® Smart Lock L2 may not operate correctly.

Installing the Linus® L2 Pull Escutcheon

1

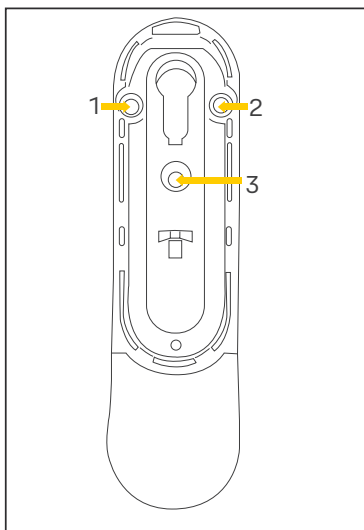

There are 3 screw placements on your new Linus® L2 Pull Escutcheon.

2

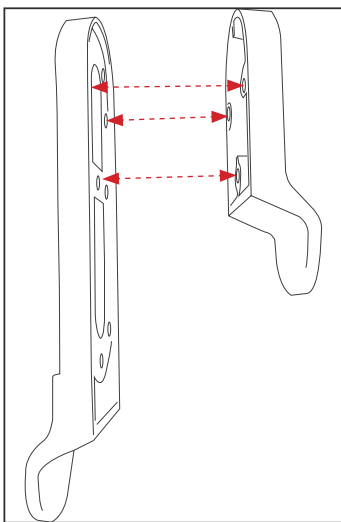

Use your existing external escutcheon to identify the correct fixing points with those on the interior Linus® L2 Pull Escutcheon.

Installing the Linus® L2 Pull Escutcheon

3

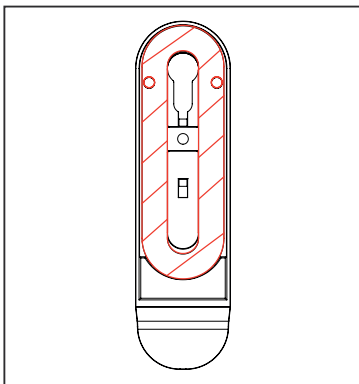

If your current escutcheons only have 2 fixing points at the top, you can choose to use the shaped 3M adhesive tape provided.

Simply peel off the backing paper from one side and position on the back of the interior escutcheon (as indicated).

Then, ensuring the escutcheon is correctly aligned with the fixing holes in the door, peel off the remaining paper backing & firmly press onto the interior side of the door.

4

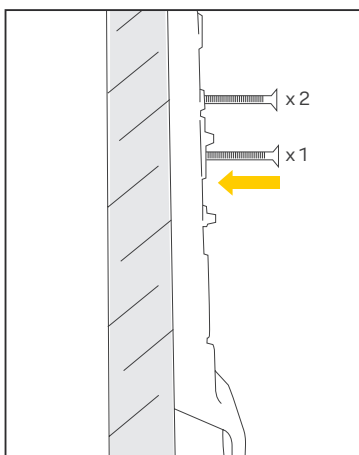

Using the correct screw length for your door, insert the screws from the inside of the door. These need to pass through the internal hardware, the door itself and fit into the fixing point on the external escutcheon.

Installing the Linus® L2 Pull Escutcheon

5

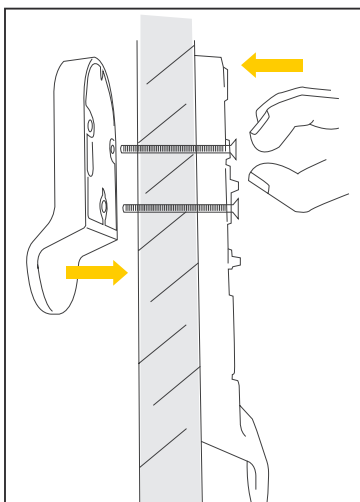

Then, position the external Linus® L2 Pull Escutcheon to the outside of your door, so the fixing points align with the protruding screws, then tighten the screws slightly by hand.

6

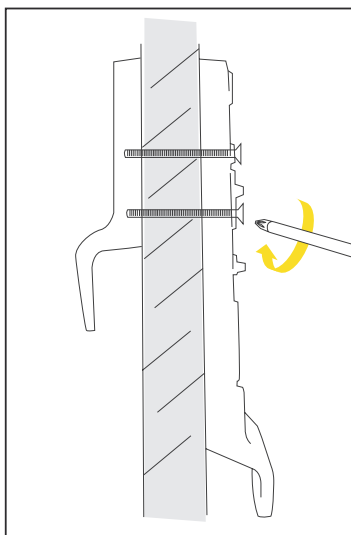

Using a cross head screwdriver, tighten the fixing screws until the escutcheons are securely attached.

Installing the Linus[®] Smart Lock L2

1

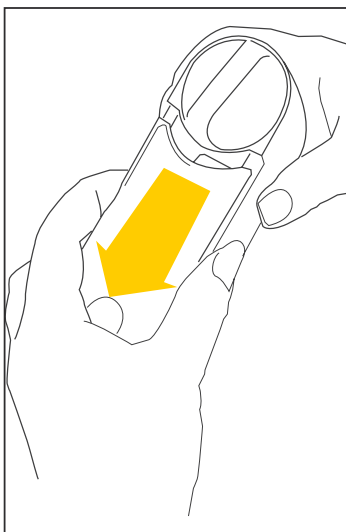

Remove the battery cover on your Linus[®] Smart Lock L2 by pulling down from the top.

2

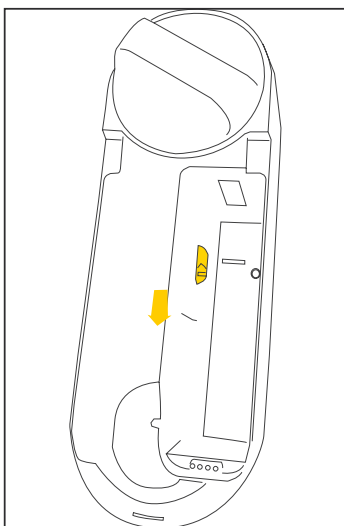

Ensure the yellow switch inside the battery compartment is in the down position. If the battery is in the compartment, please remove first.

Installing the Linus® Smart Lock L2

3

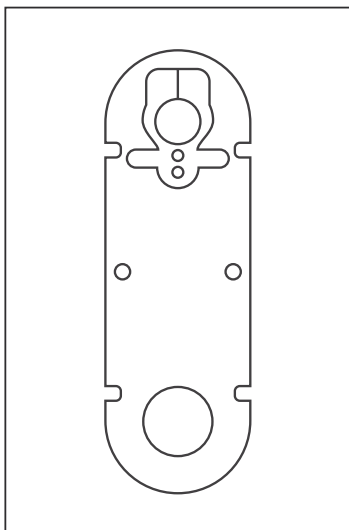

Remove the backplate from the back of your Linus® Smart Lock L2 and set aside, you will not need this.

4

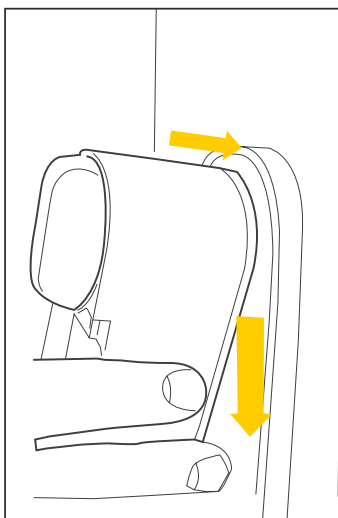

Align the Linus® Smart Lock L2 with the cradle on the escutcheon & pull down slightly until you feel it hook on to the cradle.

Installing the Linus[®] Smart Lock L2

5

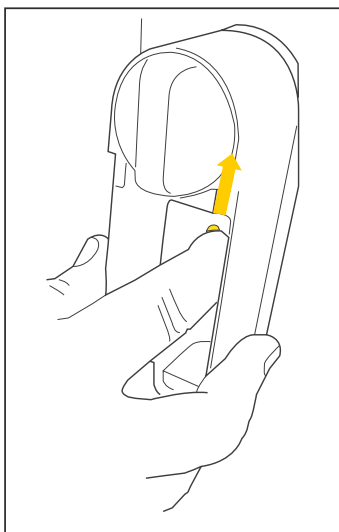

Slide the yellow switch inside the battery compartment upwards to firmly lock the Linus[®] L2 into position onto the Pull Escutcheon. Check it is securely attached by hand.

6

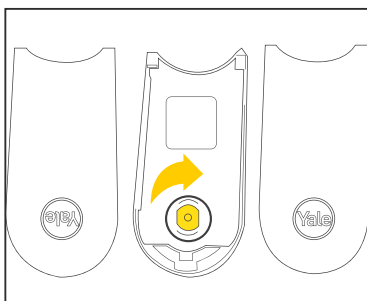

The Yale logo orientation depends on the type of lock it is installed on. To change the orientation, turn the battery cover over and locate the yellow light pipe. Gently rotate this through 180 degrees, ensuring it remains firmly attached.

Installing the Linus® Smart Lock L2

7

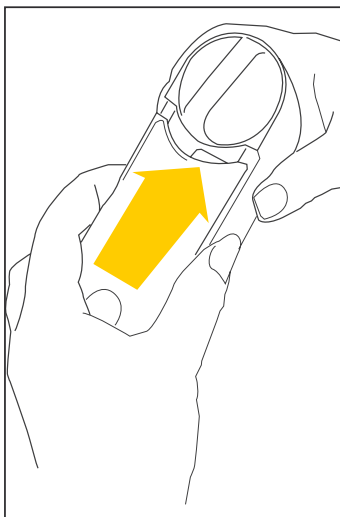

Insert the battery, ensuring the pins on the battery align with the pins in the battery compartment; then slide the battery cover back into position.

8

Now you have installed the escutcheons and lock on the door, you are ready to set up your new smart door lock.

Please download the Yale Home app and follow the in-app instructions to correctly calibrate & set up your new Linus® Smart Lock L2.

You do not need to pay attention to any comments on cylinder type in the app, as you will have already updated your cylinder at this stage if relevant.



Yale Home





For Linus® Smart Lock L2 help and support,
please scan the above QR tag.

The 2 year guarantee for this product is
active from the date of purchase.

Part of ASSA ABLOY

Consumer Support Team

Visit: yalehome.co.uk/help-support
Yale UK, School Street, Willenhall, WV13 3PW
Tel: 01824 731141

